

Installation Diagram

1. Exploded view.

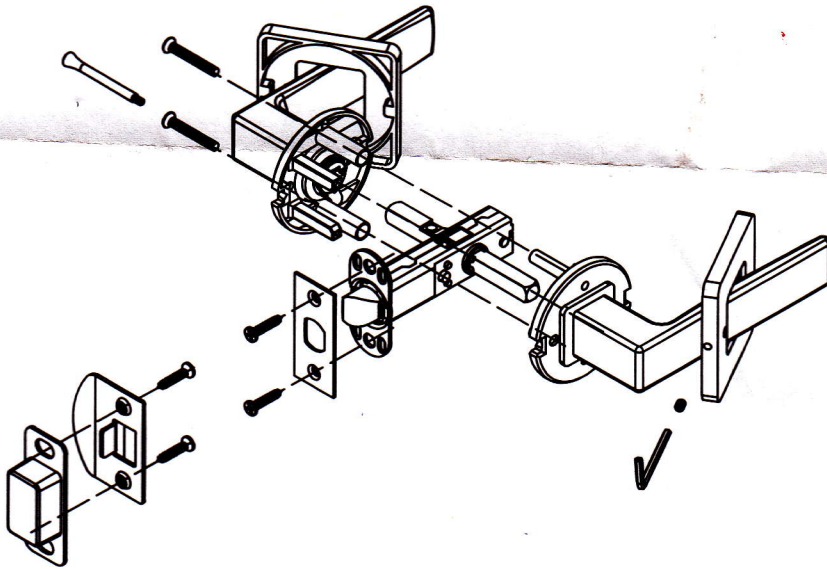

2. Rotate the latch tongue.

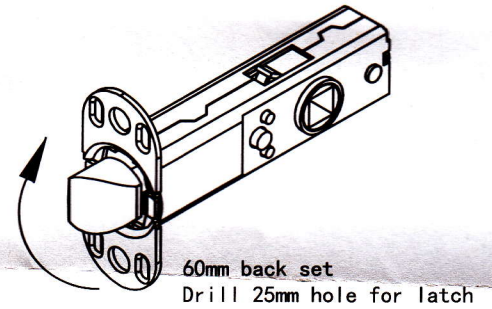

3. Drill 54mm face hole.

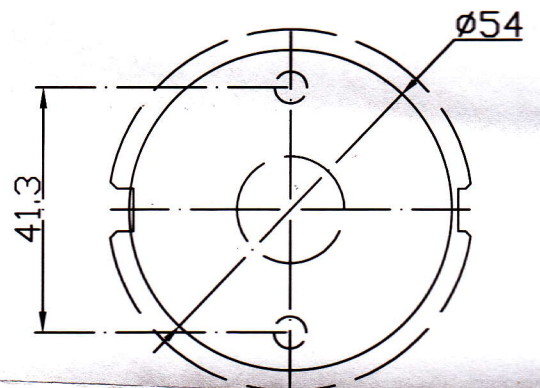

Worldwide Hardware Pty Ltd



Important Note:
Only drill holes applicable to 60mm backset.

FOLD HERE

Fit here on door edge

template

Fit here on door edge

drill 54mm (2 1/8")

BACKSET 60mm (2 3/8")

Suits doors 32mm (1 1/4") to 45mm (1 3/4") thick.